

Data Sheet

Thumbwheel Switch, Type TD

The thumbwheel switch TD is designed for one-decade input and corresponds to the front dimensions of Type T (width 10.16 mm).

All other technical data is identical with that of types T, TC and TT.

The installation depth is 27 mm.

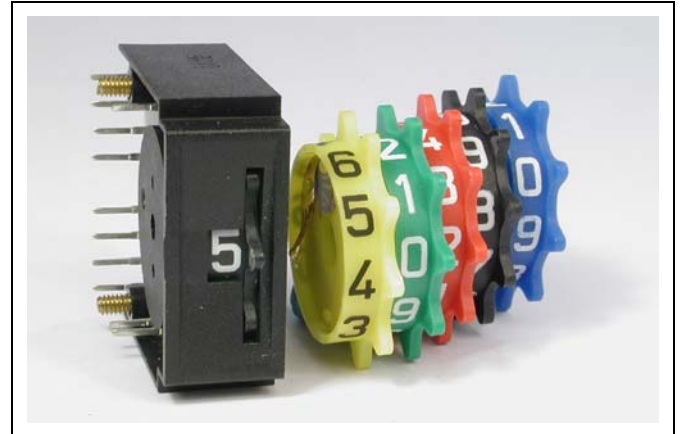

Technical Data

Rated current	≤ 0.1 A suitable for dry switching
Max. voltage	≤ 50 V=
Insulation resistance	≥ 10 ⁴ MΩ
Contact resistance	≤ 100 mΩ
Test voltage U _P contact/ contact	0.5 kV ~, 1 min.
Service life at 50 V/75 mA	> 10 ⁵ switch operations
Permissible ambient temperature δ _J	-25° ... +70°C
IEC-climatic category 68-1	25/070/21
Materials:	
Housing	Noryl
Thumbwheel	Polyamide
PC substrate	Epoxy
PC traces	Copper ≥ 1.8 μm hard gold plated over 2 μm nickel
Contact spring	Bronze CuSn6, contact AuAgNi 71/26/3 rolled to a thickness of 10 μm
Soldering	
Hand soldering	(max. 5 s) max. 340°C Suitable for mechanical soldering (using a protection foil where necessary)

Dimensions

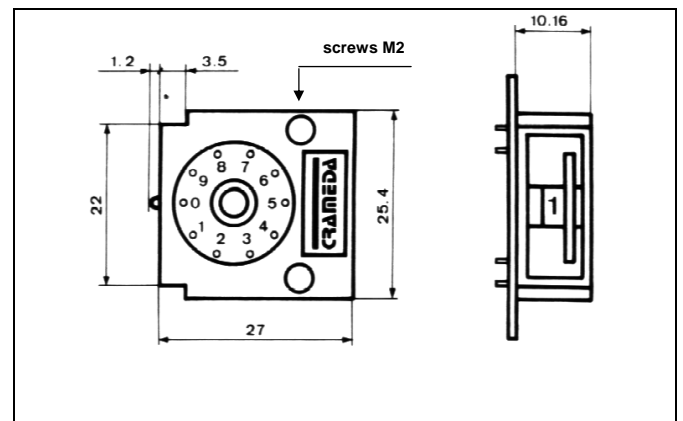

Hole pattern

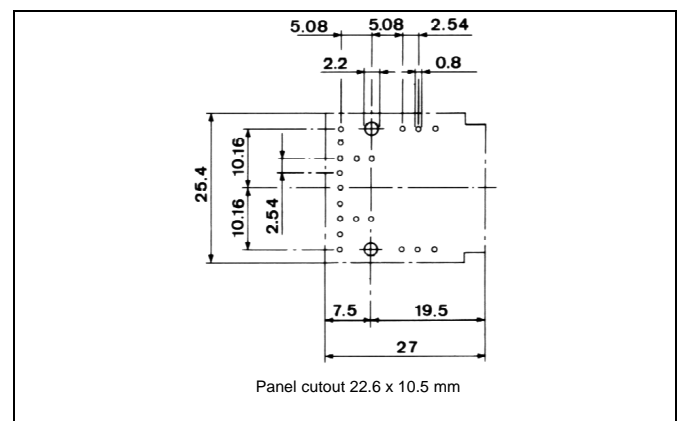

Order Number Configuration

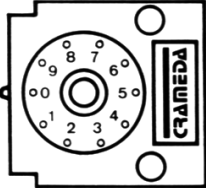
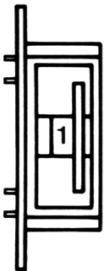
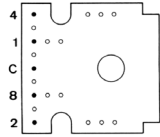
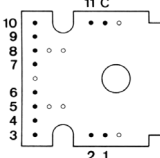
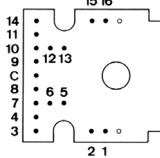
Type ①	Switching function ②			Terminals	
  <p style="text-align: center; font-weight: bold; font-size: 2em;">TD</p>	BCD-Code	10 pos.	Marking	 <p style="text-align: center;">View on conductor side</p>	
	BCD compl.	10 pos.	0-9		01
	Dual-Code	16 pos.	0-9		02
	Hexadecimal		0-15		05
	BCD-Code	11 pos.	0-9 A-F		06
			0-10	08	 <p style="text-align: center;">View on conductor side</p>
	Decimal	10 pos.	0-9	10	
	Decimal	11 pos.	0-10	11	 <p style="text-align: center;">View on conductor side</p>
	Decimal	16 pos.	0-15	16	

③ Colour of housing	black	0
④ Colour of selector disk	black	0
	red	2
	yellow	4
	green	5
	blue	6
	grey	8
⑤ Optional	End Stop	A
	Special Execution	S

Ordering Key

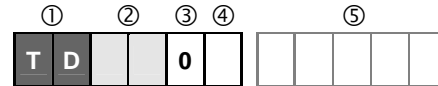

- ① Type
- ② Switching function
- ③ Housing black
- ④ Colour of selector disk
- ⑤ Optional

Order number (example)

Thumbwheel switch, type TD, switching function: decimal, housing black, selector disk black, with end stops, active switching between 1 and 14

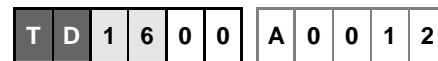

Specifications are subject to change without notice.